

Rotator Mini

FANOTECH Nodal Ninja

Quick Reference Guide

© 2012 Nodal Ninja

Support: www.nodalninja.com/forum
Tutorials: www.youtube.com/nodalninja
Store: store.nodalninja.com



Rotator Mini (RM) is a compact and low-cost alternative for Rotator D4 / D5. It features fully lubricated bearings, interchangeable detent ring, and a rotator lock screw for use atop a pole. It works for Nodal Ninja Ultimate R1/10, R10 QR clamp, QRC-35, Nodal Ninja RS1, and Rotator Footplate.

Package Contents of Rotator Mini

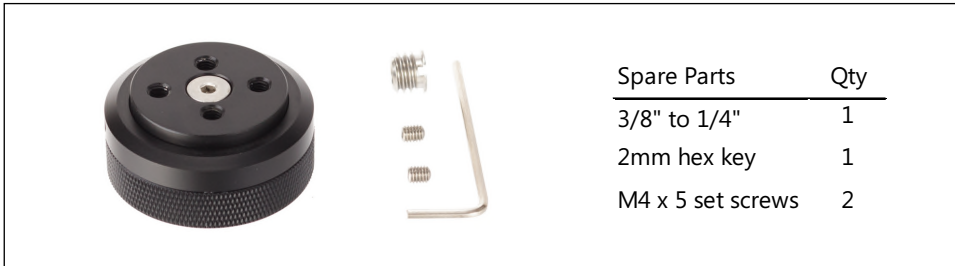

Features



- ✦ Sockets **A** (22mm separation) for mounting R1/10, RS1 and Footplate.
- ✦ Sockets **B** (18mm separation) for mounting R10 QR clamp or QRC-35.
- ✦ Interchangeable detent ring for different shooting intervals
- ✦ Rotator lock screw locks the rotator for use atop a pole

Installing Nodal Ninjas, QR Clamps or Footplate on RM



Install Nodal Ninja Ultimate R1/10, R10 QR clamp, QRC-35, Nodal Ninja RS1, or Rotator Footplate on Rotator Mini by means of two M5 flat head screws, which are supplied in the corresponding package. For best appearance, choose an orientation so that the text markings is at a less visible position.

Changing Detent Ring for Rotator Mini



Loosen two set screws on the detent ring till it can be removed from the rotator. On new detent ring, apply a thin layer of grease to the area indicated. Loosen set screws so that it can be mounted on the rotator. Clean the grease on the old detent ring and store it safely for future use.

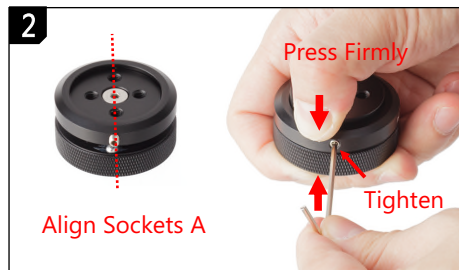

Turn the top part of the rotator to roughly align sockets **A** to the detent click ball. Mount the new detent ring. Align the set screws to the click ball. Press the ring firmly near the click ball. Tighten the set screw. Press the ring firmly near the other set screw. Tighten the set screw to finish the operations.