

# Support Bearing for Pole 2 and Pole 3

## Quick Reference Guide

© 2013 Nodal Ninja and Fanotec

Support: [www.nodalninja.com/forum](http://www.nodalninja.com/forum)  
Tutorials: [www.youtube.com/nodalninja](http://www.youtube.com/nodalninja)  
Store: [store.nodalninja.com](http://store.nodalninja.com)

# FANOTEC

## Nodal Ninja



### Pole Support Bearing for Use with Fanotec Poles

The bearing allows guy wires to be attached to pole to aid in supporting it. The ball-bearing construction prevents attached wires from twisting while pole is being rotated. Together with three guy wires, it substantially enhances stability of pole, making it ideal for using pole in strong winds and/or when the loading is near the recommended maximum. The enhanced stability also allows longer exposure to be used in low light and HDR photography. With a single guy wire, it can be used as a support or safety measure for horizontal pole application or when using the pole upside down. Support bearings are available for all Fanotec Pole Series. Guy wires are optional and sold separately.

### Contents of Support Bearing for Pole 1 and Travel Pole



### Installing Support Bearing for Pole 2 and Pole 3



1 Remove the tightening knob of the smallest section. Pull the section out. Remove the anti-twist clips.

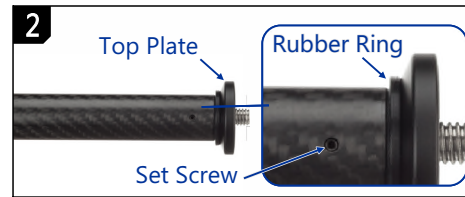

2 Remove the rubber ring below the top plate of the pole. Remove the set screws using 1.5mm hex key. Keep them in safe place for future use.



3 **For Pole 2 Only.** Skip to next step for Pole 3. Insert the Pole 2 fitting into the bearing housing. The holes on fitting should be on the same side as the exposed ball bearing.

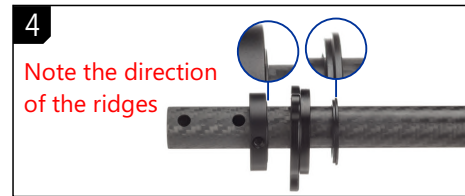

4 Insert the bearing cover, housing (with fitting in case of Pole 2) and base mount into the pole section. Note the direction of parts. The side with protruded ridge should be facing the bearing housing.

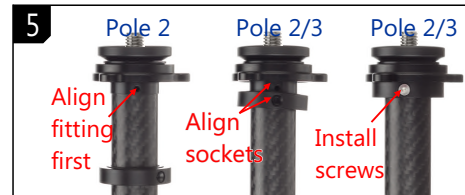

5 Push bearing parts near the top plate. In case of Pole 2, align fitting to the sockets of pole first. Then, align the base mount to the sockets. Install and tighten the M3x12mm flat head screws using a 2mm hex key.



6 Place the rubber ring (removed in **Step 2**) under the bearing assembly. Reassemble the top section back to the pole to finish the installation.



7 Any support wire/rope can be attached to holes on the bearing housing to as guy wires or safety wire. For best result, use inelastic wires.

Maintenance Note:  
If the bearing has been used in rain or at seashore, disassemble it. Wipe the ball bearing with damp cloth and then dry cloth. Grease its exposed surface and reassemble it. This prevents rusting of ball bearing.